



SHOP NOW

RFQ

HOME PRODUCTS HOW TO ORDER CASE STUDIES VIDEO GALLERY ABOUT US REQUEST CATALOG CONTACT US

Ring Pins with Washer Collars

[View Standard Items](#) [Download PDF](#) [Request Information / Quote](#)

Standard zinc-plated flat washers stamped firmly into a groove for a permanent stop. Assembly is completely plated.

Contact us for more information about Ring Pins with Collars.

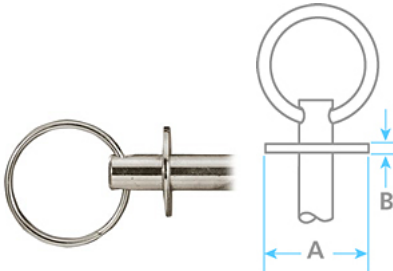

Our Exclusive Fastener Innovations ▶

Need a Custom Solution? Learn More ▶



CATEGORY BROWSE

[Home](#) > [Pins, Cotter, Rings](#) > [Ring Pins](#) > [Ring Pins with Washer Collars](#)

- Home
- Pins, Cotter, Rings
- Ring Pins
- Ring Pins with Washer Collars**

NARROW RESULTS

Search within these results

A [in]

- 7/16 (5)
- 9/16 (5)
- 3/4 (5)
- 7/8 (5)
- 1 (5)
- 1 1/4 (5)
- 1 1/2 (10)

B [in]

- 0.047 (10)
- 0.062 (5)
- 0.078 (15)
- 0.109 (10)

Material

- Alloy Steel (8)
- Low Carbon Steel (8)
- Medium Carbon Steel (8)
- Stainless Steel (300 Series) (8)
- Other (8)

Ring Pins with Washer Collars

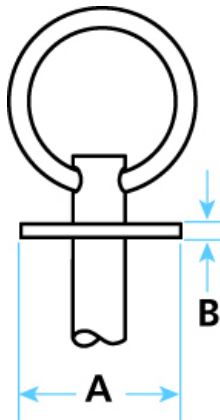

1-40 of 40 Products



Sort by: Default

Product	Pin Diameter - A [in]	A [in]	B [in]	Material
<input type="checkbox"/> Build Your Own - 3/16" Pin Diameter - Alloy Steel	3/16	7/16	0.047	Alloy Steel
<input type="checkbox"/> Build Your Own - 3/16" Pin Diameter - Low Carbon Steel	3/16	7/16	0.047	Low Carbon Steel
<input type="checkbox"/> Build Your Own - 3/16" Pin Diameter - Medium Carbon Steel	3/16	7/16	0.047	Medium Carbon Steel
<input type="checkbox"/> Build Your Own - 3/16" Pin Diameter - Stainless Steel (300 Series)	3/16	7/16	0.047	Stainless Steel (300 Series)
<input type="checkbox"/> Build Your Own - 1/4" Pin Diameter - Alloy Steel	1/4	9/16	0.047	Alloy Steel
<input type="checkbox"/> Build Your Own - 1/4" Pin Diameter - Low Carbon Steel	1/4	9/16	0.047	Low Carbon Steel
<input type="checkbox"/> Build Your Own - 1/4" Pin Diameter - Medium Carbon Steel	1/4	9/16	0.047	Medium Carbon Steel
<input type="checkbox"/> Build Your Own - 1/4" Pin Diameter - Stainless Steel (300 Series)	1/4	9/16	0.047	Stainless Steel (300 Series)
<input type="checkbox"/> Build Your Own - 5/16" Pin Diameter - Alloy Steel	5/16	3/4	0.062	Alloy Steel

<input type="checkbox"/>	Build Your Own - 5/16" Pin Diameter - Low Carbon Steel	5/16	3/4	0.062	Low Carbon Steel
<input type="checkbox"/>	Build Your Own - 5/16" Pin Diameter - Medium Carbon Steel	5/16	3/4	0.062	Medium Carbon Steel
<input type="checkbox"/>	Build Your Own - 5/16" Pin Diameter - Stainless Steel (300 Series)	5/16	3/4	0.062	Stainless Steel (300 Series)
<input type="checkbox"/>	Build Your Own - 3/8" Pin Diameter - Alloy Steel	3/8	7/8	0.078	Alloy Steel
<input type="checkbox"/>	Build Your Own - 3/8" Pin Diameter - Low Carbon Steel	3/8	7/8	0.078	Low Carbon Steel
<input type="checkbox"/>	Build Your Own - 3/8" Pin Diameter - Medium Carbon Steel	3/8	7/8	0.078	Medium Carbon Steel
<input type="checkbox"/>	Build Your Own - 3/8" Pin Diameter - Stainless Steel (300 Series)	3/8	7/8	0.078	Stainless Steel (300 Series)
<input type="checkbox"/>	Build Your Own - 7/16" Pin Diameter - Alloy Steel	7/16	1	0.078	Alloy Steel
<input type="checkbox"/>	Build Your Own - 7/16" Pin Diameter - Low Carbon Steel	7/16	1	0.078	Low Carbon Steel
<input type="checkbox"/>	Build Your Own - 7/16" Pin Diameter - Medium Carbon Steel	7/16	1	0.078	Medium Carbon Steel
<input type="checkbox"/>	Build Your Own - 7/16" Pin Diameter - Stainless Steel (300 Series)	7/16	1	0.078	Stainless Steel (300 Series)
<input type="checkbox"/>	Build Your Own - 1/2" Pin Diameter - Alloy Steel	1/2	1 1/4	0.078	Alloy Steel
<input type="checkbox"/>	Build Your Own - 1/2" Pin Diameter - Low Carbon Steel	1/2	1 1/4	0.078	Low Carbon Steel
<input type="checkbox"/>	Build Your Own - 1/2" Pin Diameter - Medium Carbon Steel	1/2	1 1/4	0.078	Medium Carbon Steel
<input type="checkbox"/>	Build Your Own - 1/2" Pin Diameter - Stainless Steel (300 Series)	1/2	1 1/4	0.078	Stainless Steel (300 Series)
<input type="checkbox"/>	Build Your Own - 5/8" Pin Diameter - Alloy Steel	5/8	1 1/2	0.109	Alloy Steel
<input type="checkbox"/>	Build Your Own - 5/8" Pin Diameter - Low Carbon Steel	5/8	1 1/2	0.109	Low Carbon Steel
<input type="checkbox"/>	Build Your Own - 5/8" Pin Diameter - Medium Carbon Steel	5/8	1 1/2	0.109	Medium Carbon Steel
<input type="checkbox"/>	Build Your Own - 5/8" Pin Diameter - Stainless Steel (300 Series)	5/8	1 1/2	0.109	Stainless Steel (300 Series)
<input type="checkbox"/>	Build Your Own - 3/4" Pin Diameter - Alloy Steel	3/4	1 1/2	0.109	Alloy Steel
<input type="checkbox"/>	Build Your Own - 3/4" Pin Diameter - Low Carbon Steel	3/4	1 1/2	0.109	Low Carbon Steel
<input type="checkbox"/>	Build Your Own - 3/4" Pin Diameter - Medium Carbon Steel	3/4	1 1/2	0.109	Medium Carbon Steel
<input type="checkbox"/>	Build Your Own - 3/4" Pin Diameter - Stainless Steel (300 Series)	3/4	1 1/2	0.109	Stainless Steel (300 Series)
<input type="checkbox"/>	Build Your Own - 3/16" Pin Diameter	3/16	7/16	0.047	Other
<input type="checkbox"/>	Build Your Own - 1/4" Pin Diameter	1/4	9/16	0.047	Other
<input type="checkbox"/>	Build Your Own - 5/16" Pin Diameter	5/16	3/4	0.062	Other
<input type="checkbox"/>	Build Your Own - 3/8" Pin Diameter	3/8	7/8	0.078	Other
<input type="checkbox"/>	Build Your Own - 7/16" Pin Diameter	7/16	1	0.078	Other
<input type="checkbox"/>	Build Your Own - 1/2" Pin Diameter	1/2	1 1/4	0.078	Other
<input type="checkbox"/>	Build Your Own - 5/8" Pin Diameter	5/8	1 1/2	0.109	Other
<input type="checkbox"/>	Build Your Own - 3/4" Pin Diameter	3/4	1 1/2	0.109	Other

CONTACT US

Pivot Point Inc.
761 Industrial Lane
PO BOX 488
Hustisford, WI 53034
Toll Free (800) 222-2231
Ph (920) 349-3251
Fax (920) 349-3253

INDUSTRIES SERVED

Military & Defense
Aerospace
Agricultural
Machine building
Automation
Transportation
Material Handling
Medical
Consumer Products
& MORE!

DISTRIBUTORS

For AUS/NC Customers



For UK Customers



WE ARE SEEKING ADDITIONAL
WORLDWIDE DISTRIBUTORS

GET SOCIAL



ABOUT US

ISO CERTIFIED
Version 9001:2008
Certificate # C0236776-ISI