



SHOP NOW

RFQ

HOME PRODUCTS HOW TO ORDER CASE STUDIES VIDEO GALLERY ABOUT US REQUEST CATALOG CONTACT US

Ring Pins with Headed Collars

[View Standard Items](#) [Download PDF](#) [Request Information / Quote](#)

One piece cold formed pin and collar for the highest durability.

Contact us for more information about Ring Pins with Collars.

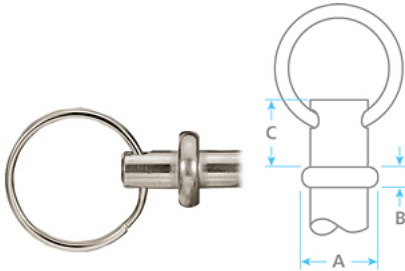

Our Exclusive Fastener Innovations ▶

Need a Custom Solution? Learn More ▶



PRODUCT DEMO VIDEOS Watch Now ▶



VIEW CATALOG View Our Full-Length Pivot Point Inc. Print Catalog. ▶

CATEGORY BROWSE

Home > Pins, Cotter, Rings > Ring Pins > Ring Pins with Headed Collars

- Home
- Pins, Cotter, Rings
- Ring Pins
- Ring Pins with Headed Collars**

NARROW RESULTS

Search within these results GO

▼ A [in]

- 5/16 (5)
- 7/16 (5)
- 1/2 (5)
- 5/8 (5)
- 3/4 (5)
- 7/8 (5)

▼ B [in]

- 0.060 (5)
- 0.090 (10)
- 0.100 (5)
- 0.125 (10)

▼ C [in]

- .75 (20)
- 0.410 (10)

▼ Material

Ring Pins with Headed Collars

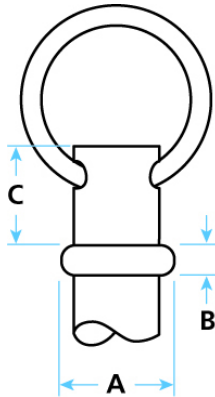

1-40 of 40 Products



Sort by: Default ▼

Product	Pin Diameter - A [in]	A [in]	B [in]	C [in]	Material
<input type="checkbox"/> Build Your Own - 3/16" Pin Diameter - Alloy Steel	3/16	5/16	0.060	0.410	Alloy Steel
<input type="checkbox"/> Build Your Own - 3/16" Pin Diameter - Low Carbon Steel	3/16	5/16	0.060	0.410	Low Carbon Steel
<input type="checkbox"/> Build Your Own - 3/16" Pin Diameter - Medium Carbon Steel	3/16	5/16	0.060	0.410	Medium Carbon Steel
<input type="checkbox"/> Build Your Own - 3/16" Pin Diameter - Stainless Steel (300 Series)	3/16	5/16	0.060	0.410	Stainless Steel (300 Series)
<input type="checkbox"/> Build Your Own - 1/4" Pin Diameter - Alloy Steel	1/4	7/16	0.090	0.410	Alloy Steel
<input type="checkbox"/> Build Your Own - 1/4" Pin Diameter - Low Carbon Steel	1/4	7/16	0.090	0.410	Low Carbon Steel
<input type="checkbox"/> Build Your Own - 1/4" Pin Diameter - Medium Carbon Steel	1/4	7/16	0.090	0.410	Medium Carbon Steel
<input type="checkbox"/> Build Your Own - 1/4" Pin Diameter - Stainless Steel (300 Series)	1/4	7/16	0.090	0.410	Stainless Steel (300 Series)
<input type="checkbox"/> Build Your Own - 5/16" Pin Diameter - Alloy Steel	5/16	1/2	0.090	.75	Alloy Steel

<input type="checkbox"/> Alloy Steel (8)	<input type="checkbox"/> Build Your Own - 5/16" Pin Diameter - Low Carbon Steel	5/16	1/2	0.090	.75	Low Carbon Steel
<input type="checkbox"/> Low Carbon Steel (8)	<input type="checkbox"/> Build Your Own - 5/16" Pin Diameter - Medium Carbon Steel	5/16	1/2	0.090	.75	Medium Carbon Steel
<input type="checkbox"/> Medium Carbon Steel (8)	<input type="checkbox"/> Build Your Own - 5/16" Pin Diameter - Stainless Steel (300 Series)	5/16	1/2	0.090	.75	Stainless Steel (300 Series)
<input type="checkbox"/> Stainless Steel (300 Series) (8)	<input type="checkbox"/> Build Your Own - 3/8" Pin Diameter - Alloy Steel	3/8	5/8	0.100	.75	Alloy Steel
<input type="checkbox"/> Other (8)	<input type="checkbox"/> Build Your Own - 3/8" Pin Diameter - Low Carbon Steel	3/8	5/8	0.100	.75	Low Carbon Steel
	<input type="checkbox"/> Build Your Own - 3/8" Pin Diameter - Medium Carbon Steel	3/8	5/8	0.100	.75	Medium Carbon Steel
	<input type="checkbox"/> Build Your Own - 3/8" Pin Diameter - Stainless Steel (300 Series)	3/8	5/8	0.100	.75	Stainless Steel (300 Series)
	<input type="checkbox"/> Build Your Own - 7/16" Pin Diameter - Alloy Steel	7/16	3/4	0.125	.75	Alloy Steel
	<input type="checkbox"/> Build Your Own - 7/16" Pin Diameter - Low Carbon Steel	7/16	3/4	0.125	.75	Low Carbon Steel
	<input type="checkbox"/> Build Your Own - 7/16" Pin Diameter - Medium Carbon Steel	7/16	3/4	0.125	.75	Medium Carbon Steel
	<input type="checkbox"/> Build Your Own - 7/16" Pin Diameter - Stainless Steel (300 Series)	7/16	3/4	0.125	.75	Stainless Steel (300 Series)
	<input type="checkbox"/> Build Your Own - 1/2" Pin Diameter - Alloy Steel	1/2	7/8	0.125	.75	Alloy Steel
	<input type="checkbox"/> Build Your Own - 1/2" Pin Diameter - Low Carbon Steel	1/2	7/8	0.125	.75	Low Carbon Steel
	<input type="checkbox"/> Build Your Own - 1/2" Pin Diameter - Medium Carbon Steel	1/2	7/8	0.125	.75	Medium Carbon Steel
	<input type="checkbox"/> Build Your Own - 1/2" Pin Diameter - Stainless Steel (300 Series)	1/2	7/8	0.125	.75	Stainless Steel (300 Series)
	<input type="checkbox"/> Build Your Own - 5/8" Pin Diameter - Alloy Steel	5/8				Alloy Steel
	<input type="checkbox"/> Build Your Own - 5/8" Pin Diameter - Low Carbon Steel	5/8				Low Carbon Steel
	<input type="checkbox"/> Build Your Own - 5/8" Pin Diameter - Medium Carbon Steel	5/8				Medium Carbon Steel
	<input type="checkbox"/> Build Your Own - 5/8" Pin Diameter - Stainless Steel (300 Series)	5/8				Stainless Steel (300 Series)
	<input type="checkbox"/> Build Your Own - 3/4" Pin Diameter - Alloy Steel	3/4				Alloy Steel
	<input type="checkbox"/> Build Your Own - 3/4" Pin Diameter - Low Carbon Steel	3/4				Low Carbon Steel
	<input type="checkbox"/> Build Your Own - 3/4" Pin Diameter - Medium Carbon Steel	3/4				Medium Carbon Steel
	<input type="checkbox"/> Build Your Own - 3/4" Pin Diameter - Stainless Steel (300 Series)	3/4				Stainless Steel (300 Series)
	<input type="checkbox"/> Build Your Own - 3/16" Pin Diameter	3/16	5/16	0.060	0.410	Other
	<input type="checkbox"/> Build Your Own - 1/4" Pin Diameter	1/4	7/16	0.090	0.410	Other
	<input type="checkbox"/> Build Your Own - 5/16" Pin Diameter	5/16	1/2	0.090	.75	Other
	<input type="checkbox"/> Build Your Own - 3/8" Pin Diameter	3/8	5/8	0.100	.75	Other
	<input type="checkbox"/> Build Your Own - 7/16" Pin Diameter	7/16	3/4	0.125	.75	Other
	<input type="checkbox"/> Build Your Own - 1/2" Pin Diameter	1/2	7/8	0.125	.75	Other
	<input type="checkbox"/> Build Your Own - 5/8" Pin Diameter	5/8				Other
	<input type="checkbox"/> Build Your Own - 3/4" Pin Diameter	3/4				Other

Power Grid Search

CONTACT US

Pivot Point Inc.
 761 Industrial Lane
 PO BOX 488
 Hustisford, WI 53034
 Toll Free (800) 222-2231
 Ph (920) 349-3251
 Fax (920) 349-3253

INDUSTRIES SERVED

Military & Defense
 Aerospace
 Agricultural
 Machine building
 Automation
 Transportation
 Material Handling
 Medical
 Consumer Products
 & MORE!

DISTRIBUTORS

For AUS/NC Customers



For UK Customers



WE ARE SEEKING ADDITIONAL
 WORLDWIDE DISTRIBUTORS

GET SOCIAL



ABOUT US

ISO CERTIFIED
 Version 9001:2008
 Certificate # C0236776-ISI