



SHOP NOW

RFQ

HOME PRODUCTS HOW TO ORDER CASE STUDIES VIDEO GALLERY ABOUT US REQUEST CATALOG CONTACT US

## Ring Pins with Crimp Collars

[View Standard Items](#) [Download PDF](#) [Request Information / Quote](#)

Crimp collars are small diameter retaining rings made of ductile 1010 carbon steel. Pressed into a groove, the collar is generally free to rotate, yet strong against end thrust. Assembly is completely plated.

Ring pins with collars are custom made per your specification, see below for standard collar dimensions. Contact us for more information about Ring Pins with Collars.

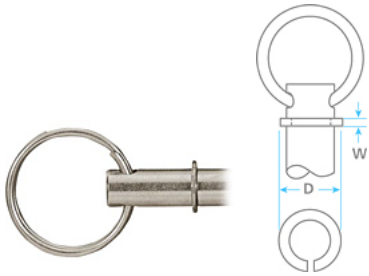

Our Exclusive Fastener Innovations

Need a Custom Solution? Learn More



CATEGORY BROWSE

[Home](#) > [Pins, Cotter, Rings](#) > [Ring Pins](#) > [Ring Pins with Crimp Collars](#)

- Home
- Pins, Cotter, Rings
- Ring Pins
- Ring Pins with Crimp Collars**

NARROW RESULTS

Search within these results

**D [in]**

- 0.250 (5)
- 0.312 (5)
- 0.406 (5)
- 0.500 (5)
- 0.594 (5)
- 0.688 (5)
- 0.859 (5)
- 1.031 (5)

**Material**

- Alloy Steel (8)
- Low Carbon Steel (8)
- Medium Carbon Steel (8)
- Stainless Steel (300 Series) (8)
- Other (8)

### Ring Pins with Crimp Collars

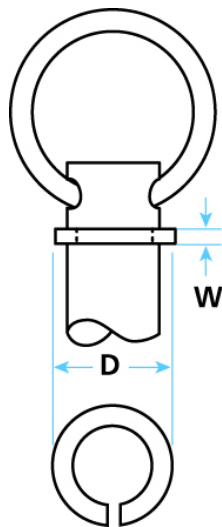

1-40 of 40 Products



Sort by:

Compare

Product	Pin Diameter - A [in]	D [in]	Thickness - W [in]	Material
<input type="checkbox"/> Build Your Own - 3/16" Pin Diameter - Alloy Steel	3/16	0.250	0.031	Alloy Steel
<input type="checkbox"/> Build Your Own - 3/16" Pin Diameter - Low Carbon Steel	3/16	0.250	0.031	Low Carbon Steel
<input type="checkbox"/> Build Your Own - 3/16" Pin Diameter - Medium Carbon Steel	3/16	0.250	0.031	Medium Carbon Steel
<input type="checkbox"/> Build Your Own - 3/16" Pin Diameter - Stainless Steel (300 Series)	3/16	0.250	0.031	Stainless Steel (300 Series)
<input type="checkbox"/> Build Your Own - 1/4" Pin Diameter - Alloy Steel	1/4	0.312	0.031	Alloy Steel
<input type="checkbox"/> Build Your Own - 1/4" Pin Diameter - Low Carbon Steel	1/4	0.312	0.031	Low Carbon Steel

Power Grid Search

<input type="checkbox"/> Build Your Own - 1/4" Pin Diameter - Medium Carbon Steel	1/4	0.312	0.031	Medium Carbon Steel
<input type="checkbox"/> Build Your Own - 1/4" Pin Diameter - Stainless Steel (300 Series)	1/4	0.312	0.031	Stainless Steel (300 Series)
<input type="checkbox"/> Build Your Own - 5/16" Pin Diameter - Alloy Steel	5/16	0.406	0.039	Alloy Steel
<input type="checkbox"/> Build Your Own - 5/16" Pin Diameter - Low Carbon Steel	5/16	0.406	0.039	Low Carbon Steel
<input type="checkbox"/> Build Your Own - 5/16" Pin Diameter - Medium Carbon Steel	5/16	0.406	0.039	Medium Carbon Steel
<input type="checkbox"/> Build Your Own - 5/16" Pin Diameter - Stainless Steel (300 Series)	5/16	0.406	0.039	Stainless Steel (300 Series)
<input type="checkbox"/> Build Your Own - 3/8" Pin Diameter - Alloy Steel	3/8	0.500	0.047	Alloy Steel
<input type="checkbox"/> Build Your Own - 3/8" Pin Diameter - Low Carbon Steel	3/8	0.500	0.047	Low Carbon Steel
<input type="checkbox"/> Build Your Own - 3/8" Pin Diameter - Medium Carbon Steel	3/8	0.500	0.047	Medium Carbon Steel
<input type="checkbox"/> Build Your Own - 3/8" Pin Diameter - Stainless Steel (300 Series)	3/8	0.500	0.047	Stainless Steel (300 Series)
<input type="checkbox"/> Build Your Own - 7/16" Pin Diameter - Alloy Steel	7/16	0.594	0.055	Alloy Steel
<input type="checkbox"/> Build Your Own - 7/16" Pin Diameter - Low Carbon Steel	7/16	0.594	0.055	Low Carbon Steel
<input type="checkbox"/> Build Your Own - 7/16" Pin Diameter - Medium Carbon Steel	7/16	0.594	0.055	Medium Carbon Steel
<input type="checkbox"/> Build Your Own - 7/16" Pin Diameter - Stainless Steel (300 Series)	7/16	0.594	0.055	Stainless Steel (300 Series)
<input type="checkbox"/> Build Your Own - 1/2" Pin Diameter - Alloy Steel	1/2	0.688	0.063	Alloy Steel
<input type="checkbox"/> Build Your Own - 1/2" Pin Diameter - Low Carbon Steel	1/2	0.688	0.063	Low Carbon Steel
<input type="checkbox"/> Build Your Own - 1/2" Pin Diameter - Medium Carbon Steel	1/2	0.688	0.063	Medium Carbon Steel
<input type="checkbox"/> Build Your Own - 1/2" Pin Diameter - Stainless Steel (300 Series)	1/2	0.688	0.063	Stainless Steel (300 Series)
<input type="checkbox"/> Build Your Own - 5/8" Pin Diameter - Alloy Steel	5/8	0.859	0.078	Alloy Steel
<input type="checkbox"/> Build Your Own - 5/8" Pin Diameter - Low Carbon Steel	5/8	0.859	0.078	Low Carbon Steel
<input type="checkbox"/> Build Your Own - 5/8" Pin Diameter - Medium Carbon Steel	5/8	0.859	0.078	Medium Carbon Steel
<input type="checkbox"/> Build Your Own - 5/8" Pin Diameter - Stainless Steel (300 Series)	5/8	0.859	0.078	Stainless Steel (300 Series)
<input type="checkbox"/> Build Your Own - 3/4" Pin Diameter - Alloy Steel	3/4	1.031	0.094	Alloy Steel
<input type="checkbox"/> Build Your Own - 3/4" Pin Diameter - Low Carbon Steel	3/4	1.031	0.094	Low Carbon Steel
<input type="checkbox"/> Build Your Own - 3/4" Pin Diameter - Medium Carbon Steel	3/4	1.031	0.094	Medium Carbon Steel
<input type="checkbox"/> Build Your Own - 3/4" Pin Diameter - Stainless Steel (300 Series)	3/4	1.031	0.094	Stainless Steel (300 Series)
<input type="checkbox"/> Build Your Own - 3/16" Pin Diameter	3/16	0.250	0.031	Other
<input type="checkbox"/> Build Your Own - 1/4" Pin Diameter	1/4	0.312	0.031	Other
<input type="checkbox"/> Build Your Own - 5/16" Pin Diameter	5/16	0.406	0.039	Other
<input type="checkbox"/> Build Your Own - 3/8" Pin Diameter	3/8	0.500	0.047	Other
<input type="checkbox"/> Build Your Own - 7/16" Pin Diameter	7/16	0.594	0.055	Other
<input type="checkbox"/> Build Your Own - 1/2" Pin Diameter	1/2	0.688	0.063	Other
<input type="checkbox"/> Build Your Own - 5/8" Pin Diameter	5/8	0.859	0.078	Other
<input type="checkbox"/> Build Your Own - 3/4" Pin Diameter	3/4	1.031	0.094	Other

## CONTACT US

Pivot Point Inc.  
761 Industrial Lane  
PO BOX 488  
Hustisford, WI 53034  
Toll Free (800) 222-2231  
Ph (920) 349-3251  
Fax (920) 349-3253

## INDUSTRIES SERVED

Military & Defense  
Aerospace  
Agricultural  
Machine building  
Automation  
Transportation  
Material Handling  
Medical  
Consumer Products  
& MORE!

## DISTRIBUTORS

For AUS/NC Customers



For UK Customers



WE ARE SEEKING ADDITIONAL  
WORLDWIDE DISTRIBUTORS

## GET SOCIAL



## ABOUT US

ISO CERTIFIED  
Version 9001:2008  
Certificate # C0236776-ISI